

Room 2, 98 Gigant Street, Salisbury, Wiltshire, SP1 2BQ

A FURNISHED ROOM ON THE FIRST FLOOR OF THIS CHARACTER THREE STOREY PROPERTY. SINGLE OCCUPANCY ONLY. INCLUSIVE OF UTILITIES.

- FURNISHED FIRST FLOOR ROOM
- SINGLE OCCUPANCY
- SHARED KITCHEN
- SHARED LOUNGE
- SHARED BATHROOM / SHOWER
- DOUBLE GLAZING
- GAS FIRED CENTRAL HEATING
- COURTYARD REAR GARDEN
- INCLUSIVE OF UTILITIES
- ****6 MONTH ONLY CONTRACT****

£475 PCM

Ground Floor

Approx. 45.1 sq. metres (485.5 sq. feet)

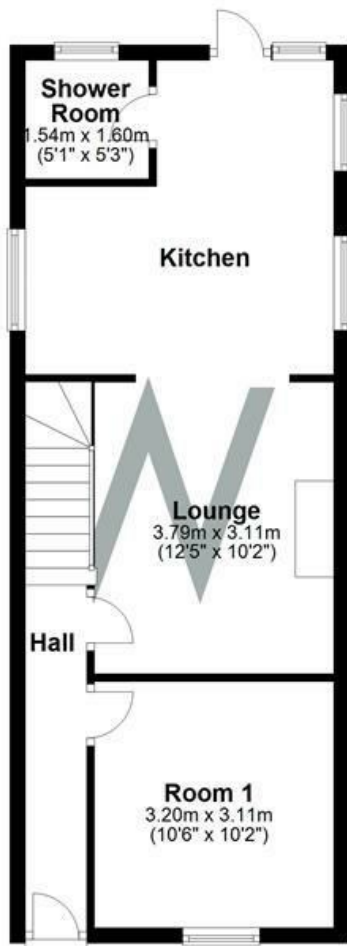

First Floor

Approx. 32.9 sq. metres (353.7 sq. feet)

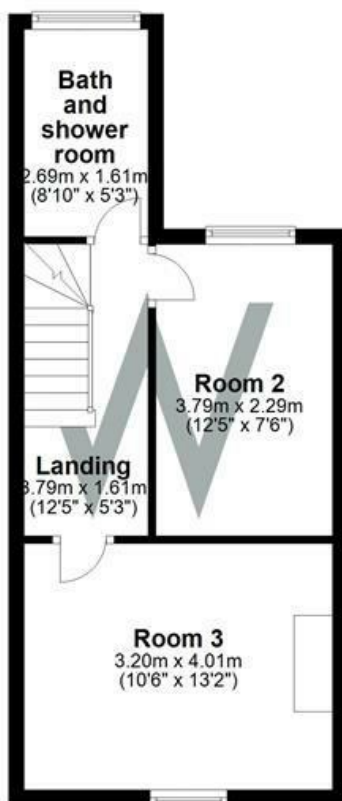

Second Floor

Approx. 28.4 sq. metres (305.4 sq. feet)

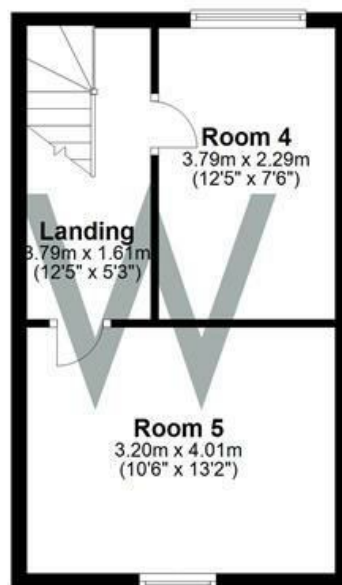

WHITES

Castle Chambers, 47 Castle Street, Salisbury,
Wiltshire, SP1 3SP

Tel: 01722 336422/Option 2

www.hwwhite.co.uk

email: lettings-management@hwwhites.co.uk

Energy Efficiency Rating		
	Current	Potential
Very energy efficient - lower running costs		
(92 plus) A		
(81-91) B		
(69-80) C		
(55-68) D		
(39-54) E		
(21-38) F		
(1-20) G		
Not energy efficient - higher running costs		
England & Wales		
	EU Directive 2002/91/EC	

Environmental Impact (CO ₂) Rating		
	Current	Potential
Very environmentally friendly - lower CO ₂ emissions		
(92 plus) A		
(81-91) B		
(69-80) C		
(55-68) D		
(39-54) E		
(21-38) F		
(1-20) G		
Not environmentally friendly - higher CO ₂ emissions		
England & Wales		
	EU Directive 2002/91/EC	